

# Six Ponds News

An Occasional Publication of the Six Ponds Improvement Association, Plymouth, Mass.

([www.sixponds.org](http://www.sixponds.org))

April, 2016



## **Focus of Six Ponds Improvement Association**

Nearly 65 years ago, the Six Ponds Improvement Association was formed to educate and inform members and area residents about issues of special concern to the Six Ponds area of Plymouth.

Major items of focus in recent years have included road and traffic issues associated with the A.D. Makepeace Redbrook development, condition and maintenance of our gravel roads, annual water quality testing of our ponds, the semiannual roadside cleanup, and last summer's botanical survey of Six Ponds shoreline areas.

Our bylaws also include broader 'community measures that may be for the benefit of the Six Ponds area.' To that end, we often bring attention to issues which could have an indirect effect on our area. This includes recent items like sand and gravel removal, town bylaws that affect our health and safety, conservation issues, dark-sky continuity, trash concerns, and municipal initiatives.

We would be glad to hear about any new concerns or ideas our members may have. Please feel free to contact us at any time at [president@sixponds.org](mailto:president@sixponds.org).



## **Road Improvements for Six Ponds Area**

After almost ten years of planning and community discussion, road improvements in the Six Ponds area are about to begin.

In 2008, the A.D. Makepeace Company received planning approval for their proposed 1200 home Redbrook development (formerly River Run) off Bourne Road, about a mile south of Halfway Pond Road. One condition of the approval was that A.D. Makepeace would undertake road improvements along the path from Route 3, Exit 3 to their development, accommodating not only traffic growth resulting from their project, but additional traffic from other sources as well.

Four of those improvements involve intersection upgrades at Long Pond Road/Clark Road, Long Pond Road/Ship Pond Road, Long Pond Road/Halfway Pond Road, and Halfway Pond Road/Bourne Road. The fifth improvement involves a signalized pedestrian crossing on Bourne Road, just north of the Plymouth South Elementary School. This upgrade is already in place.

The early planning studies, based on 2007 traffic counts, allowed for a number of possible solutions at each intersection, ranging from roundabouts to widened, signalized intersections. The final decisions were to be made after more detailed traffic and other engineering studies were done, once the project was underway. Because general traffic growth has been so great over the past ten years, the timing for implementation was accelerated, with the current designs based on new traffic counts taken in 2014.

As originally projected, roundabouts – like the one on Samoset and Water Streets on the downtown waterfront – were the preferred intersection solution for Long Pond Road at both Clark Road and Halfway Pond Roads. Over time, with more detailed study of required land takings, underground utilities, drainage demands, and substantially increased general traffic growth, the preference for traffic signals, combined with widened approaches and dedicated turn lanes, won out over roundabouts.

The Six Ponds Association has been following these deliberations closely over the years, and, particularly, in the past two years, meeting with A.D. Makepeace and Plymouth's DPW. Recently, there have been public meetings at both Plymouth South Middle School and Plymouth South Elementary School to share information about the project and take public input.

Some of these discussions and choices have been difficult. General traffic in the area has grown more rapidly than anticipated, witness the long lines of stalled vehicles at Clark and Long Pond Road at peak morning and evening hours. There has also been concern about the impact of these improvements on the general character of the area: need for substantial tree removal and clearing for off-road drainage, introduction of overhead lights at intersections, landscaping and general signage and way-finding graphics. Not all these issues have been fully resolved but there is a general agreement that the project needs to move forward to address mounting traffic concerns.

Towards that end, construction of the Ship Pond Road intersection will begin this spring, with the other intersections to follow as soon as possible. Because traffic signal installation requires state approval and specified poor intersection performance, only the Clark Road/Long Pond Road signals will be installed with the roadway changes. At the Long Pond/Halfway Pond intersection, signal installation will be done once traffic conditions reach the required threshold.

Long Pond Road /Clark Road – Clark Road west will be widened to two lanes, with enough stacking room to prevent waiting vehicles from backing up to the highway exit. Long Pond Road going south will also be widened to two lanes for a few hundred feet to allow both lanes of traffic from Clark Road to turn left simultaneously when the traffic signal is green. There will also be two lanes leading into the intersection from the south, with one lane dedicated for right turns only.

Long Pond Road/Ship Pond Road – Ship Pond Road will be redirected to intersect Long Pond Road at a right angle, with sightlines that allow for safer turns. Long Pond Road will also be slightly widened near the intersection to allow vehicles to more easily slow down while approaching the turn into Ship Pond Road. Median strips on both sides of the intersection will add to the separation of north- and south-bound traffic.

Long Pond Road/Halfway Pond Road – An additional lane will be added to the southbound roadway of Long Pond Road and eastbound roadway of Halfway Pond Road, as you approach the intersection, to allow for dedicated right-hand turns. The left lane of Halfway Pond Road will be dedicated left-turns only, under traffic signal control..

Halfway Pond Road/Bourne Road – The geometry of this intersection will be changed to emphasize the dominant traffic flow between the eastern portion of Halfway Pond Road and Bourne Road. The western leg of Halfway Pond Road will enter the intersection in a T-configuration, under stop sign control. There will be no traffic signals, only signs directing traffic around the curve and median strips to enhance separation of the two-way traffic.

All signalized intersections will have traffic sensors that respond to vehicle demand from all directions, minimizing unnecessary wait times. There are also provisions for sidewalks at the intersections and provisions for pedestrian crossing signal phases, under push-button control. All intersections are also designed to accommodate bicycle traffic.

### **Join Us!**

Why is continuing your Six Ponds membership important to YOU?

Six Ponds is your neighborhood, and the Six Ponds Improvement Association is your neighbors working to maintain the peaceful, rural nature of our neighborhood, and striving to assure our continued enjoyment of this inspired place we call home. Your membership helps the Association continue education and outreach, and supports local initiatives that are working to conserve and celebrate this unique area.

Consider your \$20 membership fee to be a contribution to your neighborhood and make this a banner membership year. Join us and/or renew your membership today! **THANK YOU!**

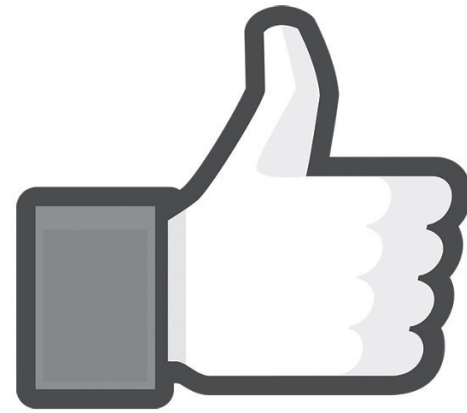

### **Find us on Facebook**

Members are invited to post news or photos that would be of interest to the whole Six Ponds community.

If you live within the Association's area and are not already a member you may log into Facebook, search for "Six Ponds," and click "Join." Perhaps you have a story about activities, animal or bird encounters, or community issues that need addressing.



*Morris dancers at last year's Annual Meeting*

## Intersection layouts

### Long Pond Road at Clark Road – Traffic Signal (Alternative 2) – Preferred

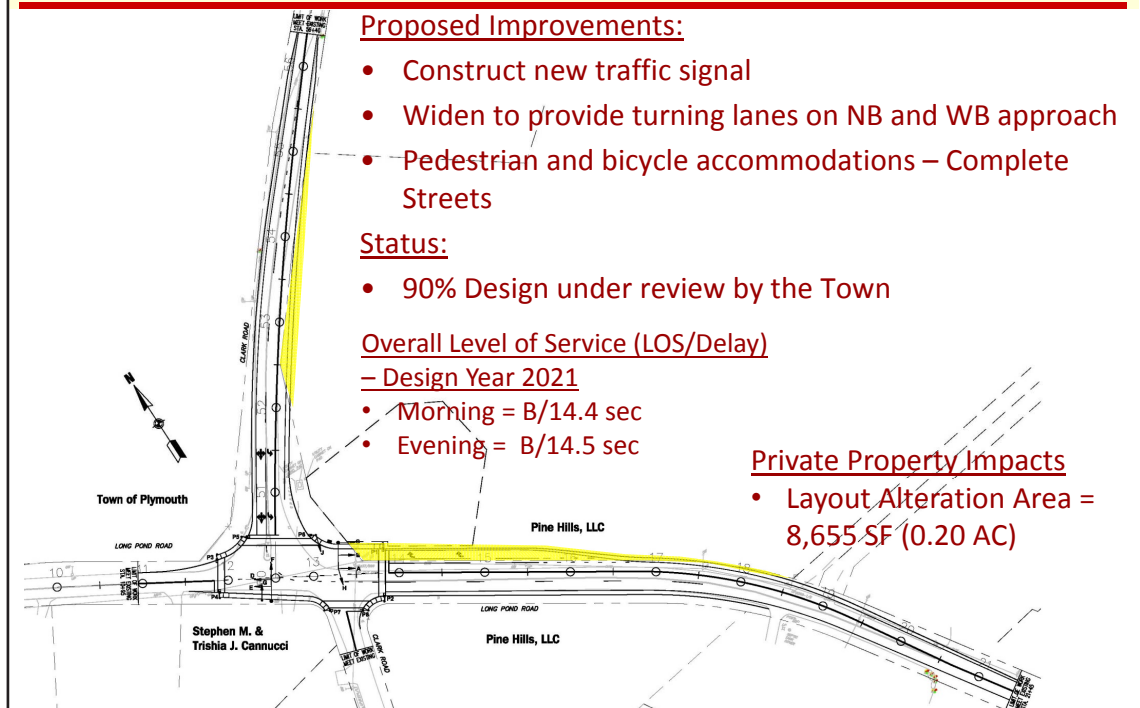

### Long Pond Road at Ship Pond Road

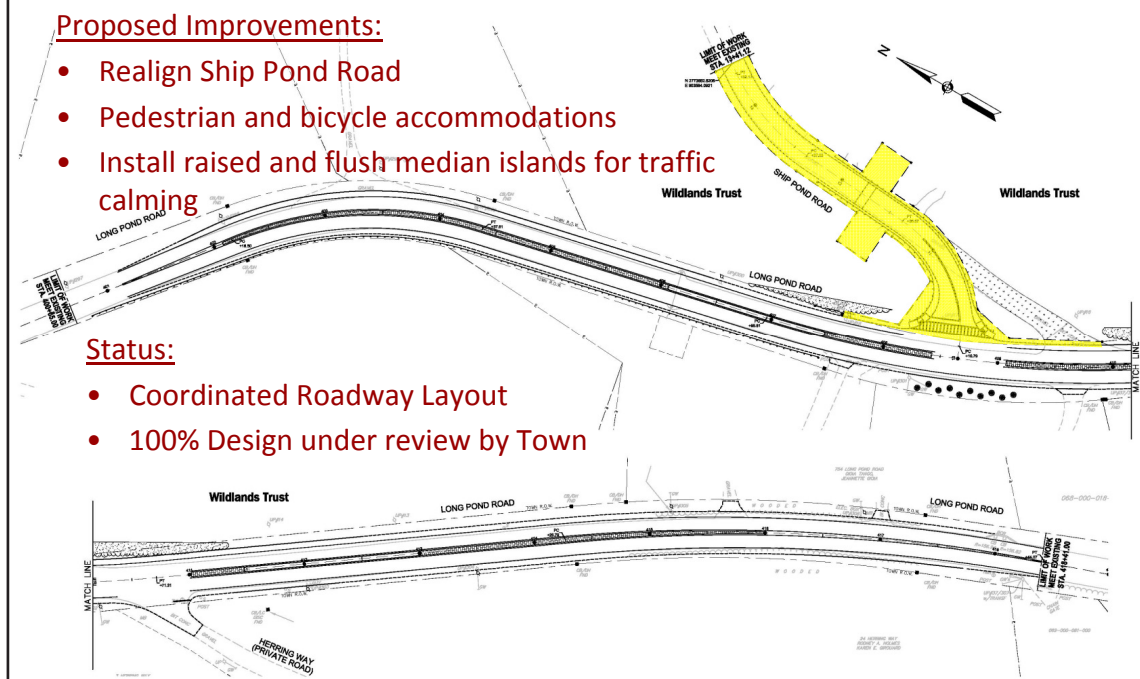

## Intersection layouts

### Long Pond Road at Halfway Pond Road & Bloody Pond Road Traffic Signal

Proposed Improvements:

- Construct new traffic signal
- Widen to provide turning lanes and 5-foot shoulders on the EB and SB approaches
- Pedestrian and bicycle accommodations

Status

- 25% Design under review by Town

Overall Level of Service (LOS/Delay)

– Design Year 2021

- Morning = C/33.4
- Evening = B/10.3

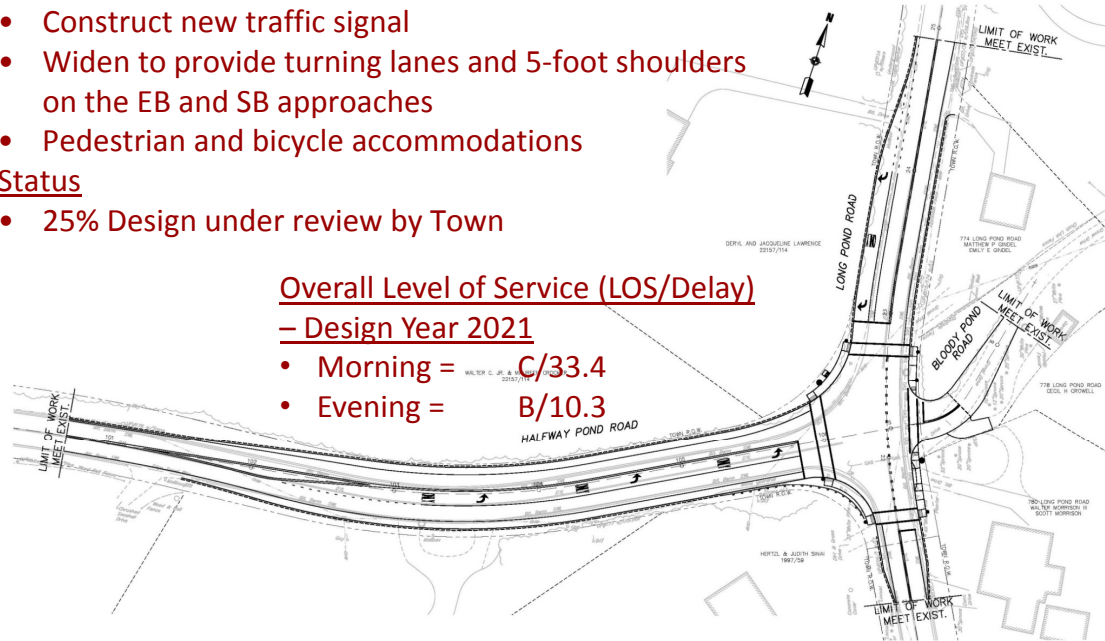

### Halfway Pond Road at Bourne Road – Realigned Intersection

Overall Level of Service (LOS/Delay)

– Design Year 2021

- Morning = A/3.1 sec
- Evening = A/2.5 sec

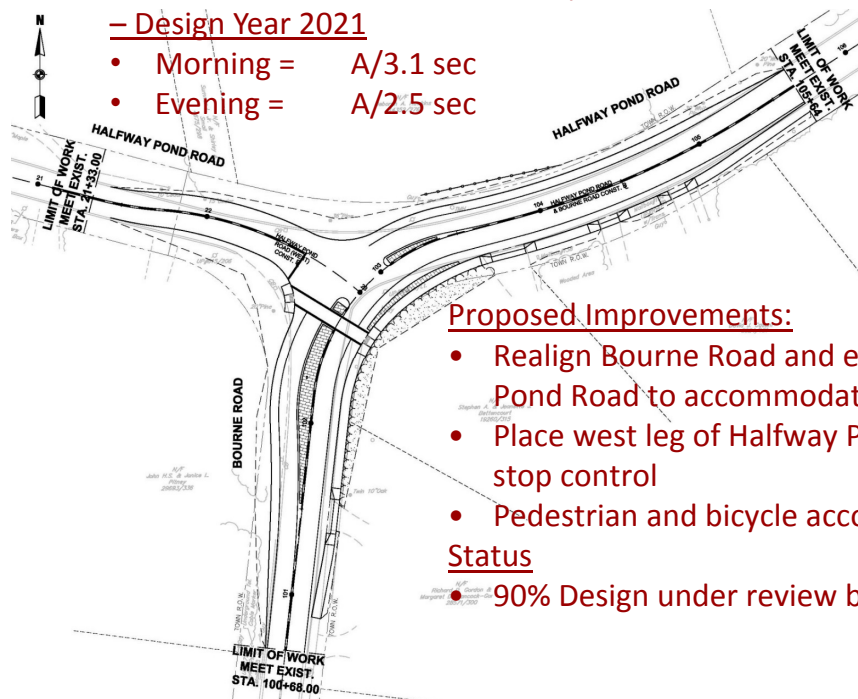

Proposed Improvements:

- Realign Bourne Road and east leg of Halfway Pond Road to accommodate through traffic
- Place west leg of Halfway Pond Road under stop control
- Pedestrian and bicycle accommodations

Status

- 90% Design under review by town

## **Pond Lovers: A Special Workshop**

Come to learn about nonnative, invasive plants and methods for controlling them in your yard, town and shorelines in a workshop on May 1 from 1 p.m. to 4 p.m. at the Spire in downtown Plymouth. To register, go to: <http://watershedaction.org>. This three-hour workshop is designed for people looking for basic information, how-to advice and local expertise.

If you have Phragmites blocking your view, knotweed taking over your yard, purple loosestrife spreading along your pond or stream, or other invasive plants that are out of control, you will enjoy (need) this workshop.

Amanda Crouch-Smith, a Professional Wetland Scientist and Certified Invasive Plant Manager, will cover the characteristics of nonnative, invasive plants, identified the most egregious ones in southeastern Massachusetts, prioritization of species for control, and control options, including mechanical, chemical and biological choices.

Several local property owners or land managers will share their experiences with small-scale projects fighting species of local concern. Lessons and advice will be applicable to a wide variety of other invasive plants.

Finally, learn from our local conservation agent, Rich Vacca, how to move forward with control projects – what regulatory processes might be required, how to find assistance and identify possible funding opportunities.

Attendees will receive useful resources, including a guide to identifying nonnative, invasive species in Massachusetts, a checklist of steps to follow, and a list of informative websites and publications.

Register soon and save \$5! The early bird fee is \$15. Workshops will be \$20 at the door. To register, go to: <http://watershedaction.org>, or leave a message for the event manager at 508-746-0769 with your name and phone number.

The workshop is organized by Watershed Action Alliance of Southeastern Massachusetts (WAA), a coalition of watershed and pond associations (including Six Ponds), which advocates and educates for healthy watersheds and clean, plentiful, free-flowing water. This workshop is hosted by the Town of Plymouth Open Space Committee.



---

### **Contributors to this issue:**

Sam Chapin, Love Albrecht Howard, Doug Post,  
Larry Rosenblum, Craig Richards, Charlotte Russell,  
Ed Russell, Dorie Stolley

## **2016 Annual Meeting**

Spring is approaching, it's time to remind the neighborhood that the annual meeting is not far off. We are happy to share the news that we will again be holding it at the Pinewoods Camp on **Sunday evening, the 12th of June**. As a tremendous added attraction, Pinewoods will be hosting its annual Community Dance that evening as well. Come and dance or come and watch - it's spirited fun.

A save the date post card will be winging its way to you shortly, followed up by a proper invitation. Please look at your June calendars now, all of them, and save 6/12/16 for a fun and informative meeting and pot-luck supper.

## **Be a Trashbuster**

Mark your calendars! The next Six Ponds and all town litter cleanup is scheduled for Saturday, April 30, rain date Sunday, May 1. Everyone is welcome and encouraged to participate in this great community builder. Meet at 10 am at the intersection of Long Pond and Clark Roads. Purple Bags and instructions will be provided but individuals should supply their own gloves and other cleanup instruments. This is a wonderful townwide cooperative event where multiple teams and hundreds of individuals participate - please join us!

---

## **The Secret Life of Plants**

Biologists Irina Kadis and Alexei Zinovjev came to Six Ponds to conduct a comprehensive survey of our shoreline plants. These results were presented to a large audience at the Plymouth Public Library on March 6. Overall they identified 306 species, including many native plant species, some rare and threatened plants, and several non-native invasive species. Attendees loved the presentation and want to know more! Stay tuned for more educational opportunities that will be offered this summer about the flora on our shorelines.

---

## **Grants & Volunteers**

Six Ponds is preparing a grant application for funding to treat polluted stormwater runoff from Plymouth Estates Roads before it reaches Little Long and Long Ponds. It will be a joint submittal with Plymouth's Department of Marine and Environmental Affairs (DMEA). There are two steps, applying for planning and design work and then for implementation.

To make the case we will collect and test stormwater runoff during three separate storm events (April, May, June). Samples are taken to a lab in Sandwich to test for phosphorus, nitrogen, suspended solids and bacteria. The Town of Plymouth pays testing costs.

Volunteers are needed to collect water from the drains during the first 15 minutes of the storm (the first flush). We will need more than three volunteers. Training will occur the first week of April. Please email Dorie at [secretary@six-ponds.org](mailto:secretary@six-ponds.org) to sign up.

---

## **Join Us!**

Why is continuing your Six Ponds membership important to YOU?

Six Ponds is your neighborhood, and the Six Ponds Improvement Association is your neighbors working to maintain the peaceful, rural nature of our neighborhood, and striving to assure our continued enjoyment of this inspired place we call home. Your membership helps the Association continue education and outreach, and supports local initiatives that are working to conserve and celebrate this unique area.

Consider your \$20 membership fee to be a contribution to your neighborhood and make this a banner membership year. Join us and/or renew your membership today! THANK YOU!

### **Six Ponds Executive Committee 2015-2016**

Love Albrecht Howard - President	Meg Harding
Sam Chapin - Vice President	Sanford Leslie
Dorie Stolley - Secretary	Nat Nichols
Doug Post - Treasurer	Craig Richards
Peter Briggs	Larry Rosenblum
Lourdeen Casoni	Charlotte Russell
Dotsie Davis	Kit Warren

## **New Town Well in Six Ponds Neighborhood**

The Town of Plymouth has started the approval process to install a new water supply well to be located in the Town-owned property between Long Pond Road and Route 3, north of Clark Road and south of the South schools. The first step is installing test wells for pump tests to measure the aquifer and determine what a reasonable withdrawal rate would be. The goal is 1.5 million gallons per day (abbreviated “MGD”). This withdrawal rate is sufficiently high to require substantial environmental impact review with public input.

Plymouth currently has 11 well stations in various parts of Town with permitted withdrawals between 0.72 MGD and 2.4 MGD, with a total permitted withdrawal of 9.77 MGD. A new source at 1.5 MGD would be substantial. Encroaching development and the expansion of land use in Town has compromised the water quality in some existing Town wells, and

it is likely that the new well is designed to replace as much as augment the existing water supply.

Of course, nobody in the Six Ponds neighborhood draws water from the public water supply; we all have our own private wells. In fact, the public water distribution system is miles away from our area, serving the downtown area, North Plymouth, Manomet, and Cedarville. The far southern part of Town is served by Bourne’s Buzzards Bay Water District. The Pinehills and the South Schools have their own water supply systems. It is unlikely that the Six Ponds area will be served by public water anytime soon.

The potential impact on our ponds will require careful study. The Six Ponds Association will keep track of the progress of the proposed new well and will inform its members when the environmental impact review commences.

